



## Housing Services Office Overview

*Housing America's Service Members and their Families*  
<https://home.army.mil/lewis-mcchord>



Updated 20210126V2

---

The JBLM Housing Services Office (HSO) offers a broad array of services for Service Members, their families and DoD Civillians. We stand ready to assist you with your housing needs and can help you by providing:

- Housing counseling and education
- Referral resources for non-discriminatory housing and temporary lodging accommodations
- Information on the Rental Partnership Program
- An overview on the local community, and programs and resources available to help you make informed decisions
- Answering questions regarding specific lease terms
- Landlord-tenant mediation and lease negotiation tips
- Home buying & selling education
- Relocation assistance for your next duty station
- Tips for PCSing homeowners who must rent or sell their home

If you are interested in off-base housing, please contact the HSO via email or phone and let our trained professionals assist you. Appointments are required for office visits. For driving directions, please refer to attached map.

### Contact Us

Housing Services Office (HSO)

Office: Bldg #5128, Pendleton Ave, Lewis Main

Hours: M-F 0800-1500 via phone and email or schedule an appointment to visit in person by calling 253-967-3581.

Phone: (253) 967-3581; Fax: (253) 967-2955

Email: [usarmy.jblm.id-readiness.list.dpw-rcd-hso@mail.mil](mailto:usarmy.jblm.id-readiness.list.dpw-rcd-hso@mail.mil)

Web: <https://home.army.mil/lewis-mcchord/index.php/my-Joint-Base-Lewis-Mcchord/all-services/directorate-public-works/HSO>

---

## Directions to Joint Base Lewis-McChord Housing Services Office from Liberty Gate

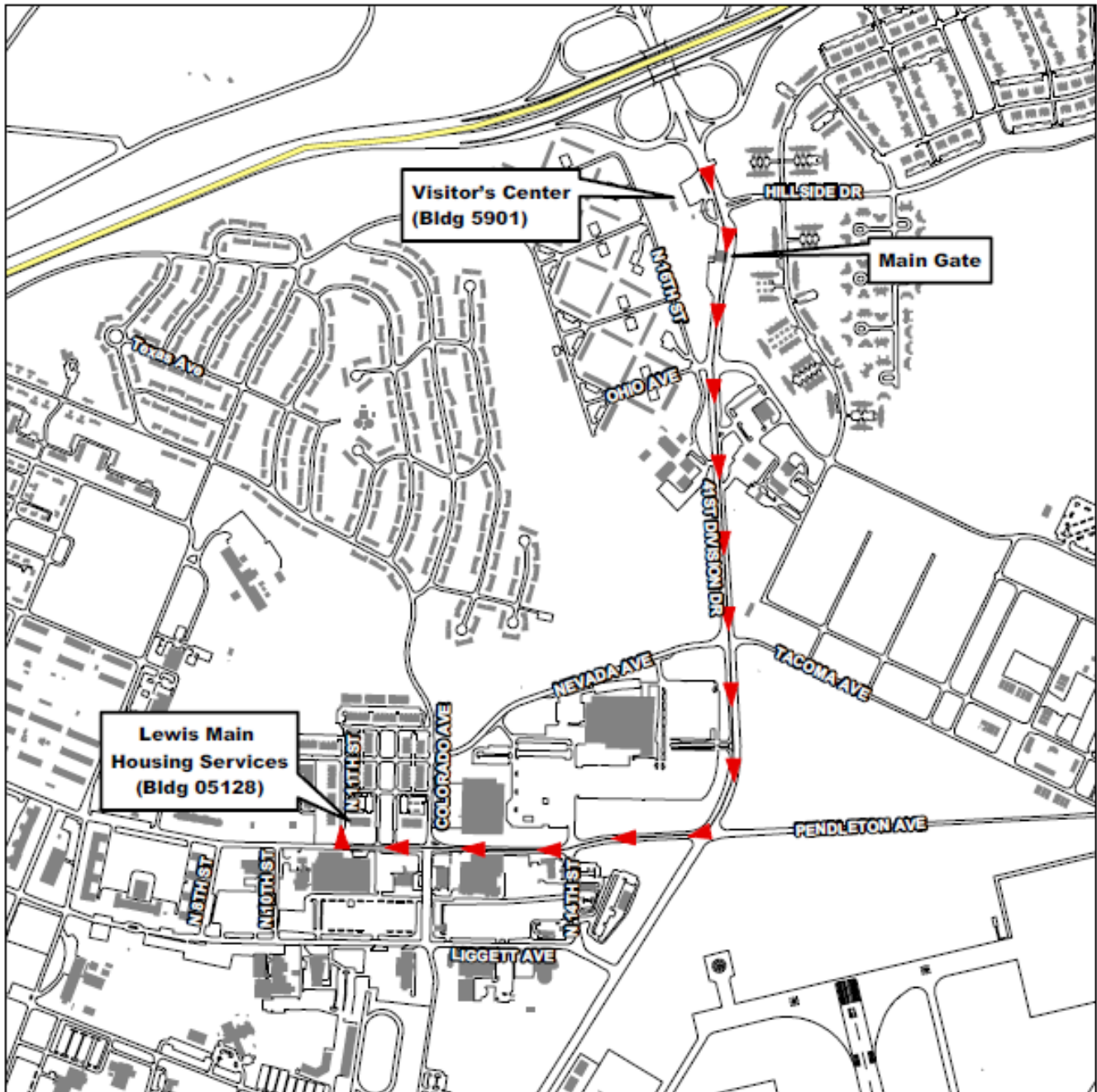

From I-5

Take exit #120, for JBLM Lewis Main.  
 Pass through the gate and proceed 3/4 of a mile.  
 Turn **RIGHT** onto Pendleton Ave and follow the road 1/2 mile.  
 Turn **RIGHT** onto N 11TH ST.  
 Building # 5128 will be on the **RIGHT**

If you need to obtain a temporary pass:  
 Take exit #120, Fort Lewis Main Gate. Stop at the Visitor Center  
 to get a pass  
 (you will need driver's license, registration & proof of insurance)



1 inch = 900 feet

0 330 660 1,320 1,980  
 Feet

Project File: L:\GIS\CommonMXDs\DirectionsTo\_RCIO\Office5128.mxd