

USER: \\ALLIED27246\FILENAME: C:\USERS\NALLIED27246\ACCDCCS\... 30056989-FORT BLISS LANDFILL PROJECT FILES\... DATE: 5/24/2022 7:07 PM PLOT DATE: 7/1/2022 5:09 PM

PROPOSED AREA TO BE ADDED TO THE BASE MASTER PLAN.
N 11576168.03
E 1207643.11
(SEE NOTE 4)

PROPOSED AREA TO BE ADDED TO THE BASE MASTER PLAN.
N 11576218.02
E 1207644.03
(SEE NOTE 4)

PROPOSED AREA TO BE ADDED TO THE BASE MASTER PLAN.
(TYP.), SEE NOTE 3

PROPOSED AREA TO BE ADDED TO THE BASE MASTER PLAN.
N 11576187.88
E 1209264.12
(SEE NOTE 4)

PROPOSED AREA TO BE ADDED TO THE BASE MASTER PLAN.
N 11576137.90
E 1209263.06
(SEE NOTE 4)

APPROXIMATE EXISTING LANDFILL LIMITS TO BE CAPPED, SEE NOTE 1 AND TYPICAL DETAIL SHEET C-7

APPROXIMATE EXISTING LANDFILL CELL LIMITS (TYP.)

EXISTING LANDFILL PERMIT BOUNDARY

PROPOSED ACCESS GATE

PROPOSED GRAVEL ROAD

PROPOSED ACCESS GATE

PROPOSED PERIMETER FENCE

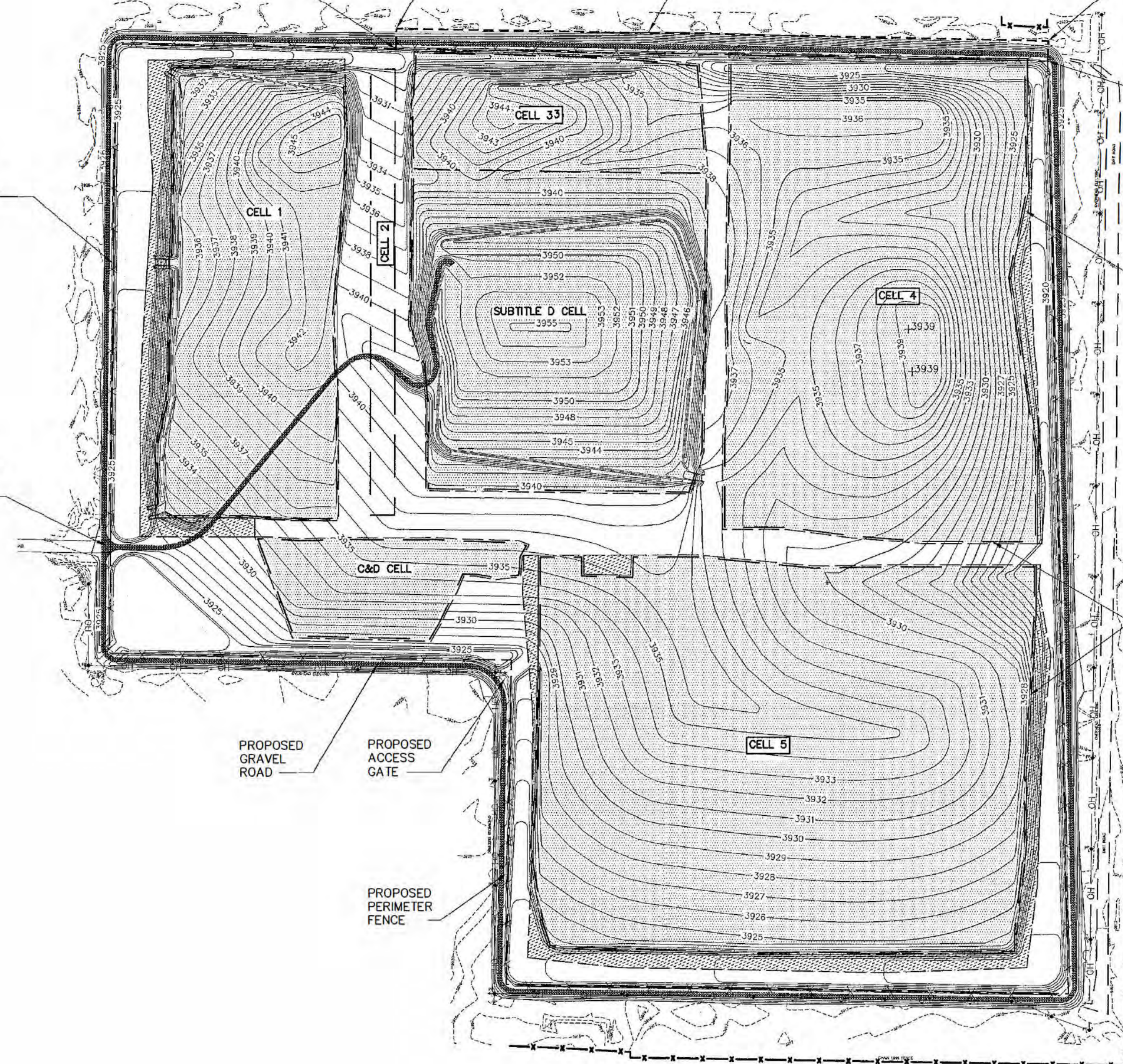

PLAN

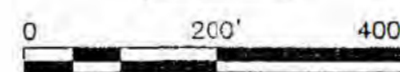

NOTES:

1. LANDFILL LIMITS SHOWN WERE DETERMINED BY THE LIMIT OF WASTE INVESTIGATION (LOW). PLEASE REFER TO THIS REPORT FOR FURTHER DETAILS. PRIOR TO CAP CONSTRUCTION, CONTRACTOR SHALL CONDUCT TEST PITS AT 100 FOOT SPACING AROUND THE PERIMETER OF EACH LANDFILL AREA TO CONFIRM THE WASTE LIMITS (EXCEPT CELL 2). THE CAP SHALL BE EXTENDED 5 FEET HORIZONTALLY BEYOND THE LIMIT OF WASTE. IF ISOLATED WASTE DEPOSITS ARE FOUND THEY WILL BE RELOCATED TO SUBTITLE D CELL OR OFF SITE AS DIRECTED BY THE CONTRACTING OFFICER.
2. ALL AREAS OUTSIDE OF THE LIMITS OF THE LANDFILL CELLS SHALL BE GRADED WITH GENERAL FILL TO GRADES SHOWN TO PROMOTE POSITIVE DRAINAGE. THE EXCEPTION WOULD BE CELL #2 WHICH WAS PREVIOUSLY CAPPED WITH A GEOMEMBRANE LINER AND WILL ONLY RECEIVE GENERAL FILL AS REQUIRED TO PROMOTE POSITIVE DRAINAGE.
3. THE PROPOSED AREA TO BE ADDED TO THE BASE MASTER PLAN ASSUMES A 50 FOOT SETBACK OF WASTE FROM THE REVISED LANDFILL LIMITS LINE. ANY WASTE LOCATED WITHIN THE 50 FOOT SETBACK SHALL BE RELOCATED INTO TO SUBTITLE D CELL OR OFF SITE AS DIRECTED BY THE CONTRACTING OFFICER.
4. SET NEW PIPE MARKERS AT THE FINAL LANDFILL BOUNDARY AS ESTABLISHED BY THE REQUIREMENTS OF NOTE 3.

LEGEND

- 3924----- EXISTING TOPOGRAPHIC CONTOUR
- EXISTING LANDFILL PERMIT BOUNDARY
- TO BE RESERVED FOR THE LANDFILL IN BASE MASTER PLAN
- 3930----- PROPOSED 5' FINAL COVER GRADES
- 3924----- PROPOSED 1' FINAL COVER GRADES
- PROPOSED GRAVEL ROAD
- PROPOSED CHAIN LINK FENCE
- APPROXIMATE EXISTING LANDFILL CELL LIMITS TO BE CAPPED
- APPROXIMATE AREA FOR ET COVER TO EXTEND



Sealed for Permitting Purposes Only

U.S. ARMY CORPS OF ENGINEERS REGIONAL PLANNING AND ENVIRONMENTAL CENTER FORT WORTH, TEXAS	DESIGNED BY: DIMESH SUBMITTED BY: DIMESH	DATE: JULY 2022	SOLICITATION NO.: CONTRACT NO.: FILE NUMBER:	PLOT SCALE: PLOT DATE: FILE NAME: FILE SIZE: ANS/D
FORT BLISS MUNICIPAL SOLID WASTE LANDFILL PERMIT MODIFICATION APPLICATION - OPTIMIZED EVAPORATION-TRANSPARATION (ET) ALTERNATIVE COVER SYSTEM	FINAL COVER CAPPING PLAN	SHEET IDENTIFICATION C-1	SHEET 4 OF 12	DATE DESCRIPTION MARK